

# Farmer's House

- **Simple Rectangle**
  - Unfired mud brick
  - Mix clay soil, straw, water
  - Dry in the sun
- **Interiors**
  - Clay plaster, painted white
  - Kitchen with open roof
  - Grindstone for milling flour
  - Small oven for baking bread
- **Roof**
  - Used for living & sleeping



# Townhouse

- **More wealthy**
  - Several rooms
  - Different levels
  - Roof used for living, cooking, and sleeping
  - Possibly gardens
- **Interiors**
  - Painted plaster
  - Some built-in ledges for dining, seating, or storage

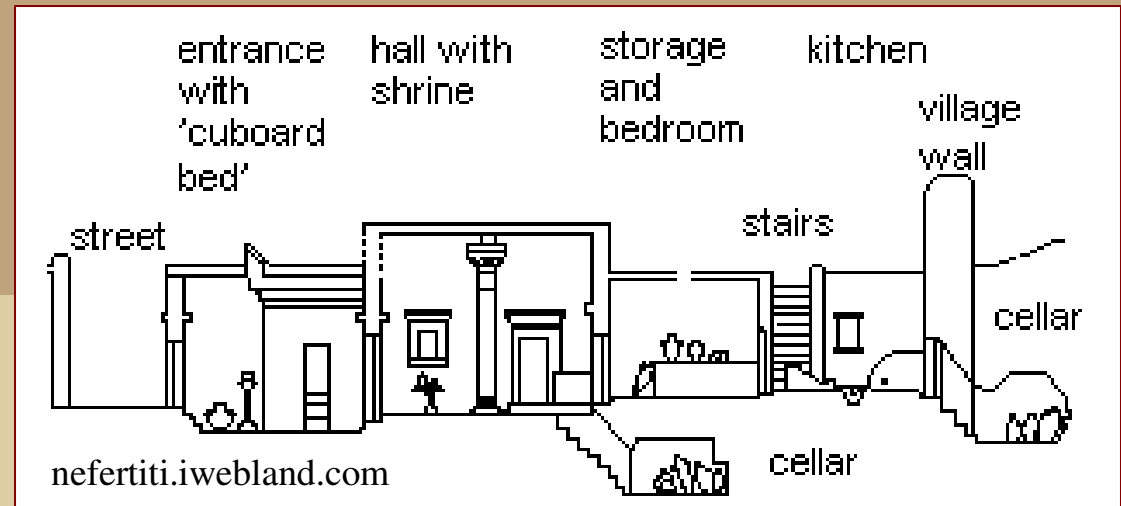

Typical Dwelling

Model of an ancient house

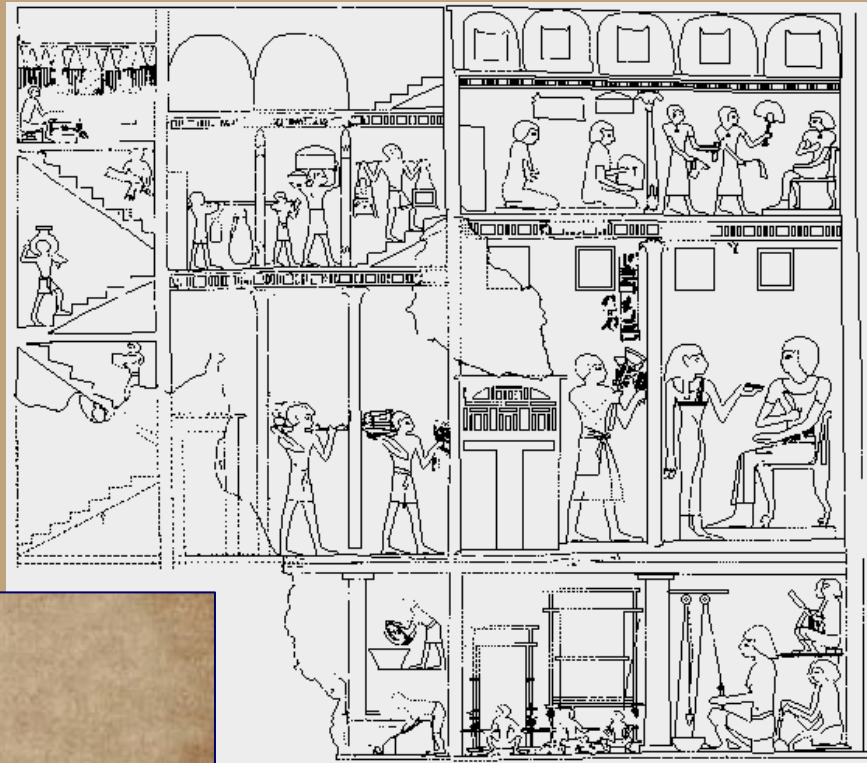

# Townhouse

# Homes of Nobility

- **Large Estate**
  - **Sandstone or Ashlar (limestone)**
  - **Gardens & servants quarters**
- **“Tripartite” floor plan**
  - 3 spaces go from public to private:
    - 1. Entryway**
    - 2. Hall or “hypostyle”**
      - **high ceiling with high windows**
      - **most important room**
    - 3. Living quarters**
      - **smaller and darker**

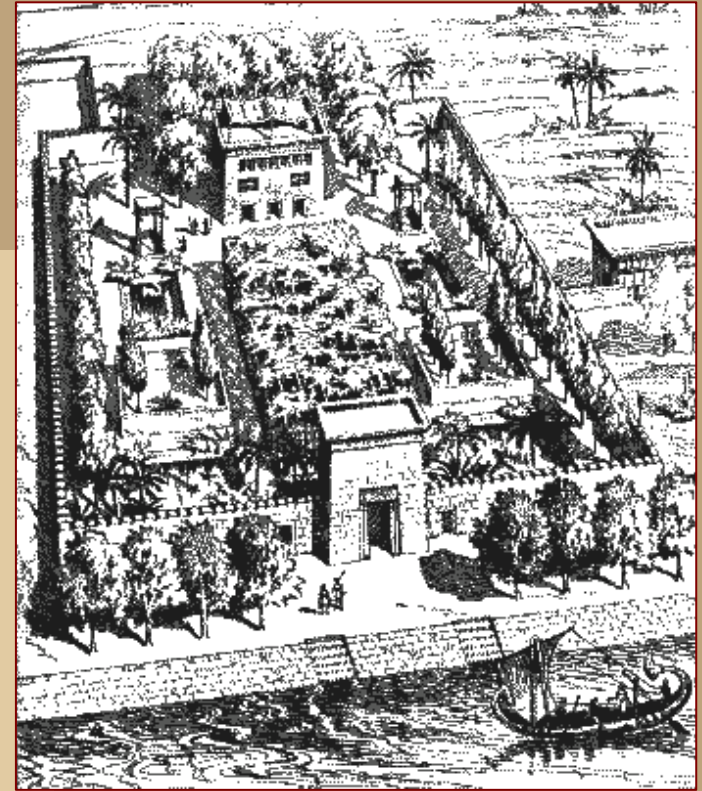

Ashlar Blocks

# Great Houses

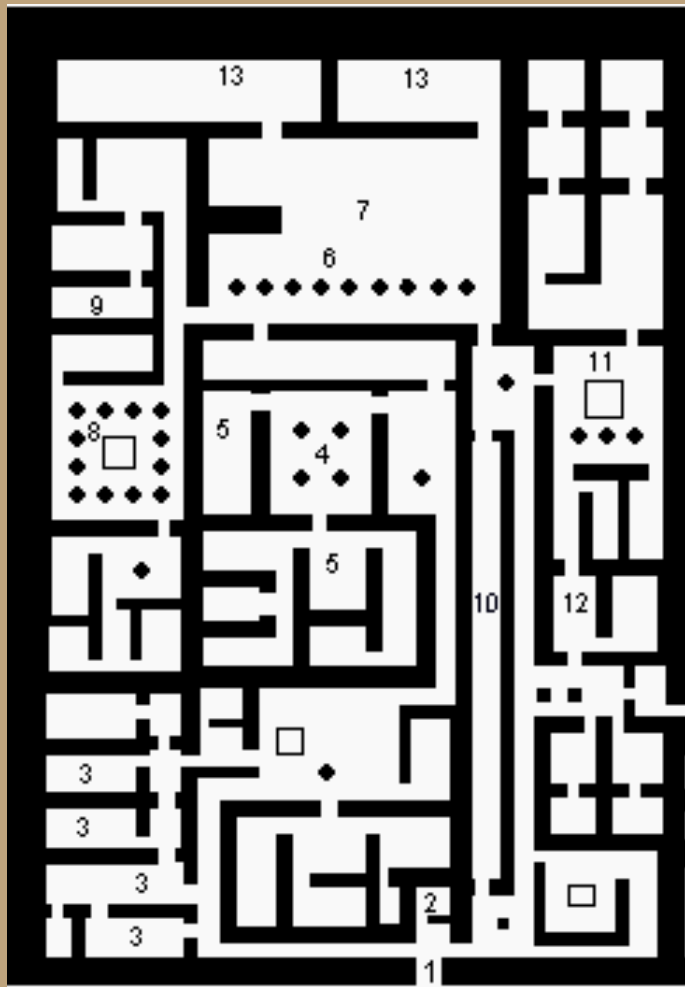

The layout of one of the northern Great Houses according to Petrie's educated guess

- 1 Main entrance
- 2 Doorkeeper's lodge
- 3 Offices, guest rooms
- 4 Pillared hall
- 5 Private quarters
- 6 The *mandara*, i.e. reception room for strangers
- 7 Open courtyard
- 8 Best hall, with columns and tank
- 9 Private rooms
- 10 Visitors' passage to the *mandara*
- 11 Women's hall
- 12 Women's quarters
- 13 Store rooms

# Homes of Nobility - Walls

- Coated with clay plaster
- Sometimes had colored tiles
- Often divided into 3 horizontal sections:
  1. Frieze or cornice
    - Decorative strip near the ceiling
    - Often “cavetto” cornice
    - Cavetto: rounded concave molding
  2. Field or filling
    - Central portion
  3. Dado
    - Lower portion



**Cavetto Cornice**

[www.buffaloah.com/a/archsty/egypt/tc.jpg](http://www.buffaloah.com/a/archsty/egypt/tc.jpg)

# Homes of Nobility - Walls

- 3 horizontal sections:
  1. Frieze or cornice
    - Decorative strip near the ceiling
  2. Field or filling
    - Central portion
  3. Dado
    - Lower portion



Tomb of Pashedu

# Windows

- To control heat and light
  - Screens - vertical or horizontal slats
  - Latticework inserts



# Ceilings

- Rough cut beams
- Wealthy homes – ceiling covered with reeds
  - Often plastered over and painted with designs inspired by religion and nature



Ceiling decoration on temples of Ramses II

# Floors

Sometimes painted plaster

